

Ten-10 H&L Cobra Line 156 Series Teeth to CHOOSE from!

Forged G.E.T. are manufactured in Tulsa, Oklahoma

Made in the USA!

All H&L Teeth are
 WARRANTED against
 premature breakage!

A
 ISO 9001-2008
CERTIFIED
 Company

Popular Cobra Line 156 Series Adapters

C-835X156
 Bottom Strap
 Weld-on Adapter
 3.5#

All lips up to 1.00"

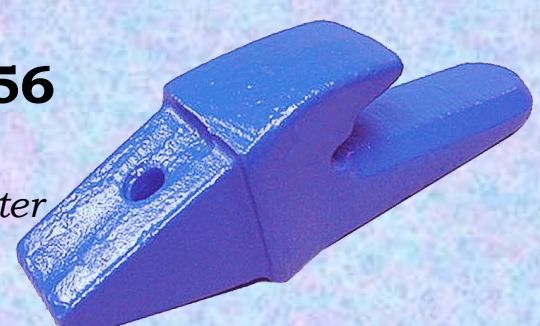

C-230X156
 Wrap Around
 Weld-on Adapter
 3.7#

Lip Size of .62"



C-550X156
 Wrap Around
 Weld-on Adapter
 4.8#

Lip Size of 1.00"



Other Cobra Style Parabolic® Teeth



Sharp Teeth Single Tiger Twin Tiger

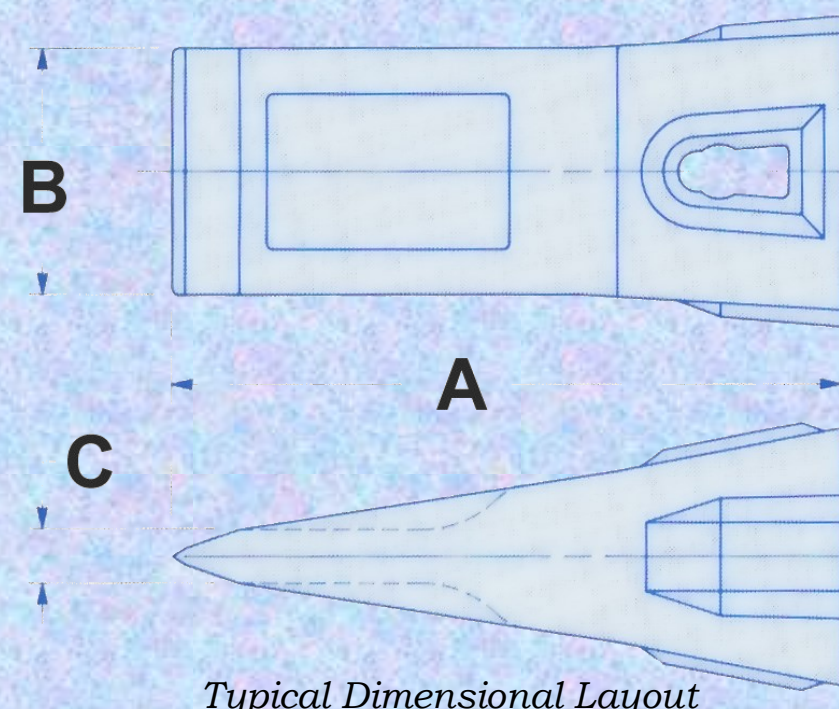

Typical Dimensional Layout

Cobra Line
 Steel Keepers Cobra Line
 Spiral Pins Cobra Line
 Flexpins

**Cobra Line Spiral pins,
 Flexpin® and Steel
 Keeper Offering!**

Sharp General Purpose and Star Teeth Line-up



Flared, Twin and Triple Tiger Teeth Line-up



SHARP PENETRATION					
GROUP	PART #	A	B	C	WEIGHT
156	CF-156SP	6.00"	2.12"	0.19"	1.8#
160	CX-160SP	6.62"	2.25"	0.19"	3.5#
220	CX-220SP	7.00"	2.75"	0.25"	6.4#
225	CX-225SP	7.00"	2.75"	0.25"	6.2#
290	CX-290SP	8.00"	3.12"	0.38"	8.2#
295	CX-295SP	8.00"	3.25"	0.25"	8.2#
310	CX-310SP	7.62"	3.31"	0.25"	7.6#
330	CX-330SP	9.12"	3.62"	0.38"	11.5#
350	CX-350SP	10.75"	4.00"	0.38"	16.0#
370	CX-370SP	10.38"	4.00"	0.38"	18.1#
400	CX-400SP	9.75"	4.25"	0.38"	16.5#
410	CX-410SP	11.38"	4.50"	0.38"	20.5#
450	CX-450SP	12.50"	4.88"	0.38"	30.2#
475	CX-475SP	12.12"	5.75"	0.50"	34.8#

SINGLE TIGER					
GROUP	PART #	A	B	C	WEIGHT
156	CX-156T	5.88"	0.19"	0.19"	1.9#
160	CX-160T	8.38"	0.25"	0.19"	4.2#
220	CX-220T	7.75"	0.25"	0.25"	6.2#
225					
290	CX-290T	9.75"	0.25"	0.25"	8.1#
295					
310	CX-310T	9.75"	0.25"	0.25"	10.7#
330	CX-330T	11.00"	0.25"	0.38"	11.2#
350					
370	CX-370T	12.00"	0.25"	0.25"	18.2#
400	CX-400T	12.06"	0.38"	0.38"	16.3#
410	CX-410T	13.38"	0.38"	0.38"	21.7#
450	CX-450T	15.00"	0.31"	0.38"	31.3#
475	CX-475TL	13.75"	0.38"	0.50"	36.8#

TWIN TIGER					
GROUP	PART #	A	B	C	WEIGHT
156	CX-156WT	6.00"	3.25"	0.19"	3.5#
160	CX-160WT	8.00"	3.44"	0.19"	5.5#
220	CX-220WT	7.88"	4.12"	0.25"	8.6#
225					
290	CX-290WT	9.50"	4.25"	0.25"	10.1#
295					
310	CX-310WT	9.50"	4.75"	0.25"	12.6#
330	CX-330WT	9.12"	3.62"	0.38"	14.7#
350					
370	CX-370WT	12.00"	6.00"	0.25"	21.0#
400	CX-400WT	12.19"	6.12"	0.38"	23.7#
410	CX-410WT	13.62"	6.62"	0.38"	27.6#
450	CX-450WT	15.00"	7.25"	0.38"	37.5#
475	CX-475WTL	14.00"	7.00"	0.38"	37.6#