

# RhombicGETsystem™

DIAGONALLY PINNED TOOTH SYSTEMS FOR

MINI-EXCAVATORS, SKID-STEERS, BACKHOES, LOADERS & EXCAVATORS

136e, 186e, 200e, 201e, 350, 351, 450 and 451 Series Teeth



136e SERIES	A	B	C	D	E	F	WEIGHT	STYLE	REPLACES
L-3761-A-136e	.38"	0	3.50"	1.19"	1.75"	.56"	2.0#	1A - Roll Pin	CAT 138-6410
L-3760-A-186e	.62"	15	5.12"	2.12"	2.00"	.69"	4.8#	1A - Roll Pin	CAT 135-9390
D-835-136e	.75"	30	4.12"		WELD-ON		2.0#	1CW - Roll Pin	H&L D-835-2A
D-834-186e	.88"	30	4.00"		WELD-ON		3.5#	1CW - Roll Pin	H&L D-834-3C
2740-ZW-200e	1.00"	23	5.62"		WELD-ON		4.5#	1W - Pin & Retainer	H&L 2740-ZW-23
2740-ZW-201e	1.00"	23	5.62"		WELD-ON		4.5#	1W - Flexpin	H&L 2740-ZW-23
3746-W-350	1.25"	20	10.00"		WELD-ON		25.0#	1CW - Pin & Retainer	
3746-W-351	1.25"	20	10.00"		WELD-ON		25.0#	1CW - Flexpin	
3748-CW-350	1.50"	30	9.25"		WELD-ON		26.3#	1CW - Pin & Retainer	ESCO 5855-V39
3748-CW-351	1.50"	30	9.25"		WELD-ON		26.3#	1CW - Flexpin	ESCO 5855-V39
3750-CW-450	2.00"	30	11.00"		WELD-ON		55.5#	1CW - Pin & Retainer	ESCO 5856-V43
3750-CW-451	2.00"	30	11.00"		WELD-ON		55.5#	1CW - Flexpin	ESCO 5856-V43
L-3749-AW-450	2.38"	25	10.62"		WELD-ON		58.5#	1W - Pin & Retainer	ESCO 4889-V43
L-3749-AW-451	2.38"	25	10.62"		WELD-ON		58.5#	1W - Flexpin	ESCO 4889-V43
3747-CW-450	2.50"	30	11.88"		WELD-ON		59.2#	1CW - Pin & Retainer	ESCO 5857A-V51
3747-CW-451	2.50"	30	11.88"		WELD-ON		59.2#	1CW - Flexpin	ESCO 5857A-V51

## RhombicGETsystem™ ADAPTER DIMENSIONS

1A STYLE  
Bolt-on ADAPTERS

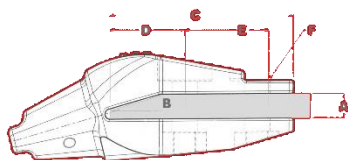

1CW STYLE  
Weld-on ADAPTERS

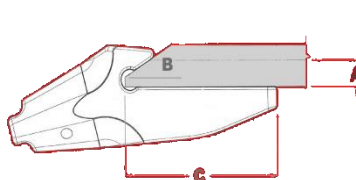

1W STYLE Weld-on  
ADAPTERS

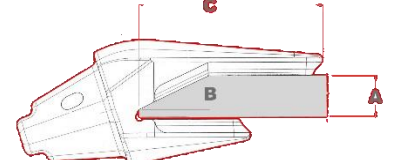

© H&L Tooth Company 2015