

H&L® TOOTH COMPANY *Vertical-Pin* TOOTH SYSTEMS

H&L Teeth are **UNIFORGED®** in the USA from high silicon Chromium-Moly-Nickel alloy steels, enhancing *durability and long life!*



SP style... Flexhol 546SP and Hammerless 646SP

Sharp Penetrating Tooth
Centerline general purpose tooth for general duty mining applications. Paneled design for penetration.



RXH style... Flexhol 546RXH and Hammerless 646RXH

Rock Extra Heavy Tooth
Heavier tooth design for severe duty front end loaders and shovels. Provides greater wear material for enhanced life.



RPS style... Flexhol 546RPS and Hammerless 646RPS

Rock Penetrating Star Tooth
Provides high wear material and is paneled for self-sharpening. Narrow tooth width provides greater penetration.

© H&L Tooth Company 2015

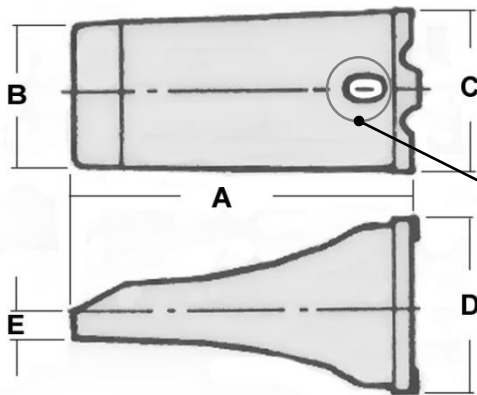

SP & RXH Style Tooth

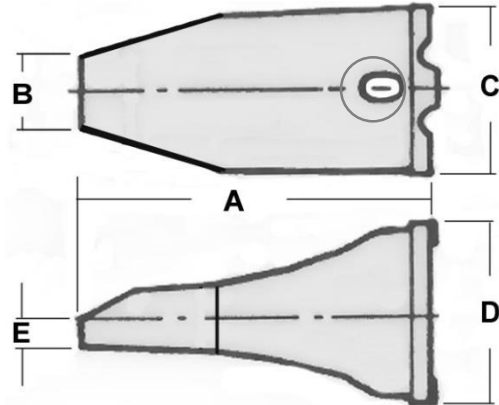

RPS Style Tooth

PART #	LENGTH "A"	WIDTH "B"	TOOTH "C"	HEIGHT "D"	END "E"	WEIGHT
546SP-R	20.00"/508mm	8.00"/203mm	9.00"/229mm	10.00"/254mm	1.50"/38mm	185#/84kgs
546RPS-R	20.00"/508mm	3.50"/89mm	9.00"/229mm	10.00"/254mm	1.50"/38mm	185#/84kgs
546RXH-R	20.00"/508mm	8.00"/203mm	9.00"/229mm	10.00"/254mm	1.50"/38mm	215#/98kgs
646SP-R	20.00"/508mm	8.00"/203mm	9.00"/229mm	10.00"/254mm	1.50"/38mm	185#/84kgs
646RPS-R	20.00"/508mm	3.50"/89mm	9.00"/229mm	10.00"/254mm	1.50"/38mm	185#/84kgs
646RXH-R	20.00"/508mm	8.00"/203mm	9.00"/229mm	10.00"/254mm	1.50"/38mm	215#/98kgs