

T159.2016

QUALITY
since 1931

H&L's Capital Trencher Adapters are produced from aircraft quality Chrom-Moly-Nickel grade alloy steels to enhance adapter **DURABILITY** and **TOUGHNESS!**

© H&L Tooth Company 2016

H&L Tooth Company History since 1931:

The Snaploc's original concept was developed in early 1985, H&L received a United States patent in September 1986. It was designed to attach a digging tooth to an adapter. One of it's first application was for Capital Trencher in the form of a 2A and 3C trencher bucket wheel version. H&L 2X and 3X number "3-SLP" Snaploc connection became the OEM offering for Capital trenching machines during the 1980s. The locking insert went out of production as a tooth-to-nose connection by 1990 and was obsolete.

In 1999 the "#3-SLP Snaploc was reintroduced into the field as a large mining shroud key-to-clamp locking device for the Bucyrus 495 Whisler equipped shovels.



H&L Part #3-SLP Snaploc

ORIGINAL PRODUCT

H&L® TOOTH COMPANY

Factory Direct Made in Tulsa, Oklahoma

The "OEM" Adapter Style for Capital Trencher

Snaploc Tooth Design

OEM Adapters, Teeth and Snaploc Pin

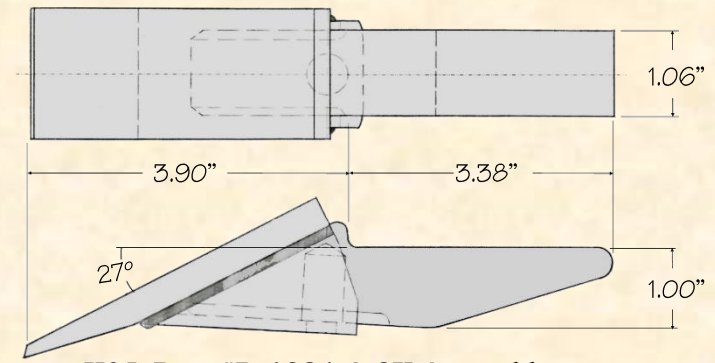

H&L Part #D-1091-A-2X Assembly

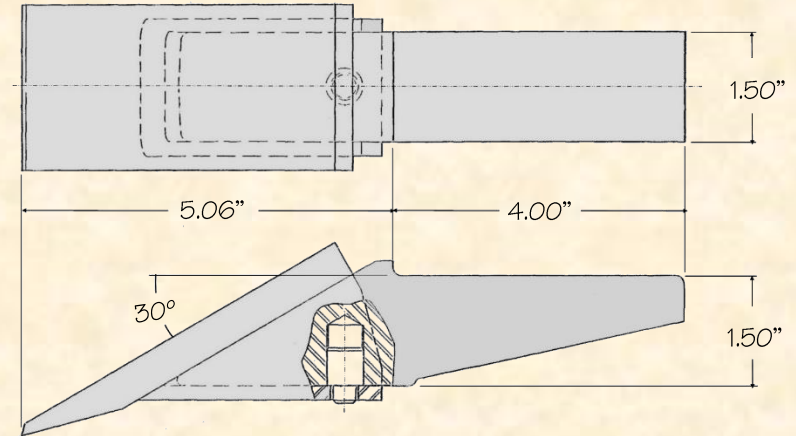

H&L Part #D-1092-3X Assembly

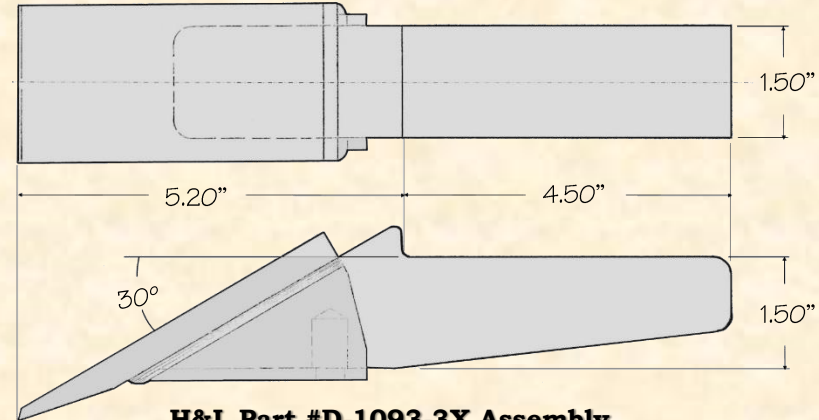

H&L Part #D-1093-3X Assembly