

T165.2016

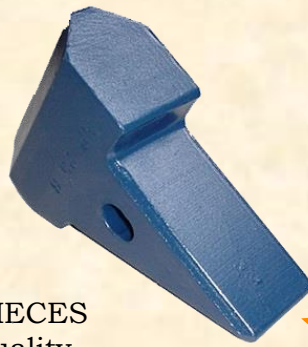

© H&L Tooth Company 2016



Offset Style #1

Centerline Style #2

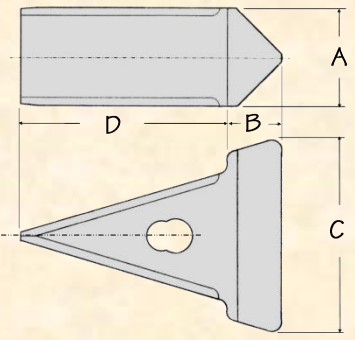
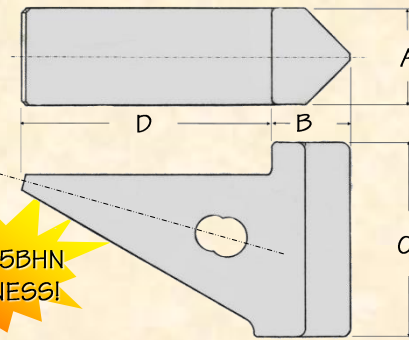

H&L's "NP-B" REPAIR NOSEPIECES are produced from aircraft quality Chrom-Moly grade alloy steels to enhance tool **DURABILITY** and **TOUGHNESS!**

H&L Tooth Company History since 1931:

In the early 1970 H&L developed a series of butt weld-on nosepieces to convert existing buckets to an H&L Tooth Flexpin system. As adapter noses wear during extreme operational digging, these same weld-on nosepieces became a great repair item for existing H&L teeth. Many of our "NP-B" style nose attachments were adopted by the OEMs of the day.

Most of the listed nosepieces, because of inactivity, are not a stock item. Some products remains in our Tulsa inventory, please give H&L Customer Service a call. Butt weld nosepieces will be made by specific sales orders only.

ORIGINAL PRODUCT

H&L® TOOTH COMPANY

Factory Direct Made in Tulsa, Oklahoma

NP-XXB Style

Repair or Conversion Weld-on Nosepieces

Nose #	Style	A	B	C	D	Wt.
NP-18B	2	2.50"	2.31"	5.12"	4.38"	12.4#
NP-20B	2	2.88"	2.40"	4.20"	3.75"	10.5#
NP-21B	1	1.00"	1.00"	3.00"	4.25"	2.5#
NP-22B	1	1.25"	1.00"	3.50"	4.25"	3.1#
NP-23B	2	1.50"	0.81"	3.00"	3.12"	2.0#
NP-24B	1	1.50"	1.19"	3.00"	4.00"	3.3#
NP-25B	1	2.00"	2.12"	4.00"	3.81"	6.9#
NP-27B	1	2.88"	2.62"	4.00"	4.00"	10.8#
NP-31B	2	3.25"	2.75"	5.06"	4.06"	17.5#
NP-32B	2	3.75"	2.88"	5.75"	4.38"	23.0#
NP-33B	2	4.50"	3.25"	7.00"	5.00"	39.0#
NP-36LB	2	3.75"	3.75"	7.00"	7.62"	35.0#
NP-41B	2	5.38"	4.00"	8.50"	9.00"	80.0#
NP-43B	2	8.50"	4.00"	11.00"	8.25"	96.0#
NP-46B	2	8.50"	4.00"	11.00"	8.00"	99.0#
NP-315B	2	4.50"	2.75"	5.06"	4.12"	23.0#
NP-325B	2	5.00"	3.00"	7.40"	5.12"	38.0#