

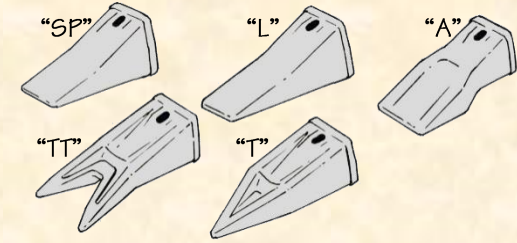

© H&L Tooth Company 2017

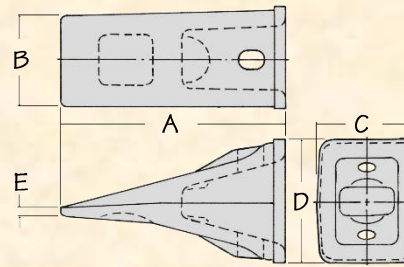

H&L's "VP" Vertical Pinned teeth are produced from aircraft quality Chrom-Moly grade alloy steels to enhance tool **DURABILITY** and **TOUGHNESS!**

H&L Tooth Company History since 1931:

In the early 1980's H&L Tooth launched a new tooth line for the OEM and Dealer markets. The VP system featured a double locking vertical Flexpin tooth-to-adapter connection. The vertical Flexpin patented system was originally used on large mining shovels of the day and downsized to the 195, 205, 315, 325 and 325 series.

H&L's VP system is no longer being produced. The chart listing on this page reflects products that remains in-stock located at our forge facility's in Tulsa, Oklahoma.

All H&L forging are made in the USA!

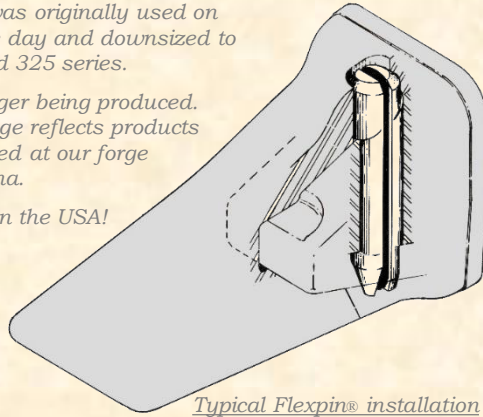

Typical Flexpin® installation

Nose #	A	B	C	D	E	Wt.
195L	8.00"	2.75"	3.12"	3.81"	0.25"	7.4#
195T	8.38"	0.19"	3.12"	3.81"	0.25"	8.2#
205A	8.50"	3.48"	3.50"	4.00"	0.50"	12.0#
205L	8.88"	3.06"	3.50"	4.00"	0.25"	10.5#
205SP	7.85"	3.06"	3.50"	4.00"	0.25"	9.5#
315A	9.50"	4.12"	4.00"	4.44"	0.31"	16.5#
315L	10.00"	3.62"	4.00"	4.44"	0.38"	15.3#
325A	11.50"	5.12"	5.12"	5.25"	0.62"	31.5#
325L	11.50"	4.50"	5.12"	5.25"	0.50"	26.0#
325SP	10.50"	4.50"	5.12"	5.25"	0.50"	25.0#
335A	13.00"	6.12"	6.12"	5.69"	0.75"	52.0#
335SP	11.00"	5.50"	6.12"	5.69"	0.50"	35.0#
335TT	13.19"	6.75"	6.12"	5.69"	0.50"	38.0#

ORIGINAL PRODUCT

H&L® TOOTH COMPANY

Factory Direct Made in Tulsa, Oklahoma

"VP" Series Teeth

OBSOLETE Vertical Flexpin Style Attachment

"VP" Flexpin Dimensional Chart

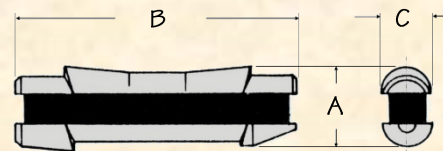

Flexpin #	A	B	C
195FP	1.02"	3.38"	0.56"
205FP	1.08"	3.88"	0.56"
315FP	1.33"	4.12"	0.75"
325FP	1.40"	4.88"	0.84"
335FP	1.50"	5.40"	0.90"