

# BOTTOM STRAP (1CW) WELD-ON ADAPTERS

© H&amp;L Tooth Company 2023

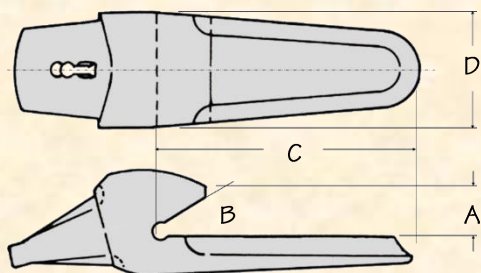

**Cobra Line 1CW conical designed Adapter**

Style	Adapter No.	A	B	C	D	Wt.
1CW	C-833-18	1.00"	30°	3.75"	2.25"	3.7#
1CW	C-855-25	1.44"	30°	5.38"	3.00"	8.5#
1CW	C-855-30	1.44"	30°	5.62"	3.50"	8.8#

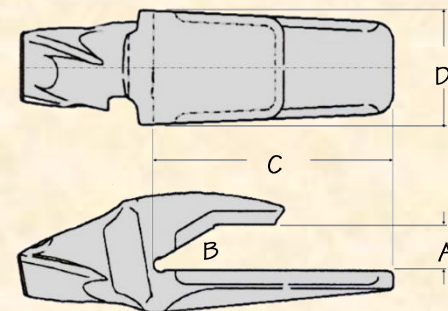

**Cobra Line 1CW super twist Style Adapter**

Style	Adapter No.	A	B	C	D	Wt.
1CW	C-5849-V23	1.31"	30°	6.00"	3.50"	12.8#
1CW	C-5850-V29	1.62"	30°	10.00"	3.50"	17.0#
1CW	C-5855-V29	1.62"	30°	9.50"	4.00"	24.9#
1CW	C-5856-V39	2.00"	30°	10.38"	4.50"	35.3#
1CW	C-5856-V43	2.00"	30°	10.50"	5.25"	50.0#

## COBRA LINE PRODUCTS

# H&L<sup>®</sup> TOOTH COMPANY

Shipped Factory Direct from Tulsa, Oklahoma

## Cobra Line Style Adapters

conical design nose; 18, 25, 30 Series  
super twist; V23, V29, V33, V39, V43 Series

*H&L Tooth Company History since 1931:*

*Since the late 1980s, H&L has offered the most popular weld-on adapters for the Cobra Line tooth systems. C-833-18, C-855-25, C-855-30, C-5849-V23, C-5850-V29, C-5855-V33, C-5856-V39, C-5856-V43.*

*Other part numbers associated with this Cobra Line Tooth-to-Adapter attachment: 833-18, 855-25, 855-30, 5856-V39, 5855-V33, 5856-V43, 5849-V23, 5850-V29.*